

STAND	COORDINATES	STAND	COORDINATES
1	513015.77N 0000259.83E	10	513016.69N 0000239.87E
2	513015.84N 0000257.58E	12	513016.72N 0000237.06E
3	513015.89N 0000255.31E	13	513016.85N 0000234.64E
4	513015.95N 0000253.16E	14	513016.94N 0000232.95E
5	513016.02N 0000251.14E	15	513018.02N 0000226.95E
6	513016.11N 0000248.91E	21	513015.09N 0000302.15E
7	513016.18N 0000246.67E	22	513015.02N 0000304.40E
8	513016.26N 0000244.40E	23	513014.95N 0000306.67E
9	513016.32N 0000242.15E	24	513014.87N 0000308.92E

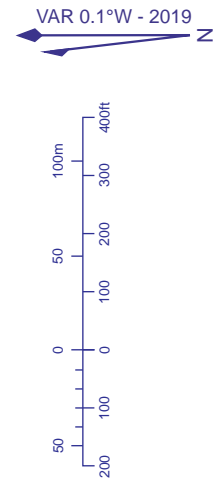

LIGHTING	DESCRIPTION
APCH 27	462m HI C/L with 2 bars.
APCH 09	401m HI C/L with 2 bars.
THR 27	Flush HI green with HI green W bars.
THR 09	Elev HI green with HI green W bars.
RWY 09	HI Colour Coded C/L (15m spacing). HI bi-d edge. Yellow edge for final 450m. (First 99m red). End lights red.
RWY 27	HI Colour Coded C/L (15m spacing). HI bi-d edge. Yellow edge for final 450m. (First 74m red). End lights red. Blue edge on turning area.
TWY	Yellow C/L, blue edge on curves. Red stop bars with yellow RWY guard lights at holds.

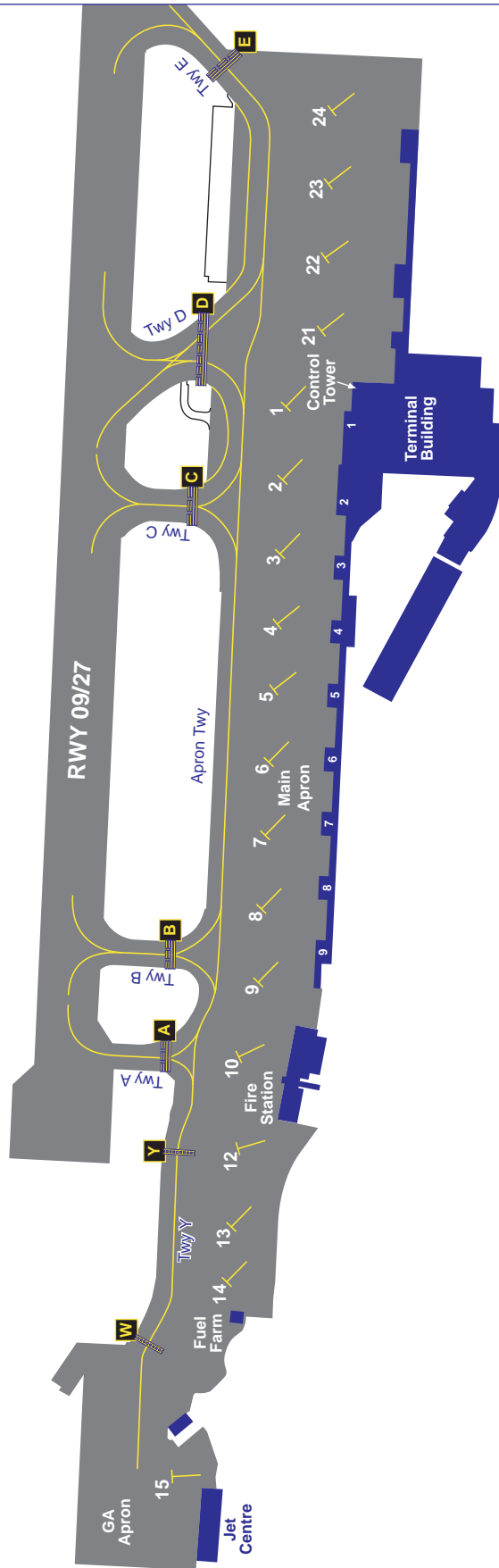

RUNWAY/TAXIWAY/APRON PHYSICAL CHARACTERISTICS			
APRON / RWY / TWY	SURFACE	BEARING STRENGTH	ELEVATION
RWY 09/27	Grooved Asphalt	43/F/C/W/T	-
Main Apron	Concrete	30/R/C/Y/T	17ft amsl
Main Taxiway	Concrete	30/R/C/Y/T	-

COM		CITY INFORMATION	
ATIS	136.355	CITY TOWER	
TWR	118.080	CITY GROUND	
	121.830 (GMC)	(as directed by ATC)	
	129.455	CITY FIRE	
	121.600		